



501/215 Boundary Street Coolangatta QLD

2  2  1 

Perfectly positioned in the heart of Rainbow Bay, apartment 501 is one of only nineteen residential apartments and only two per floor. Located on the fifth floor of Eden Apartments, is this stylish spacious furnished apartment designed to capture the natural light and ocean breezes.

Modern in design, with an open plan living area that extends to the spacious balcony where you can admire the surrounds. A designer kitchen complete with stone bench tops and breakfast bar, gas cooking, dishwasher, a suite of quality stainless steel appliances and plenty of storage.

Master suite with private balcony, walk in robe, and is complemented by the ensuite with a double basin, shower, and a private spa bath to soak away at the end of the day.

[For full version visit the website](https://www.topperrealestate.com.au)

Type : Apartment
Price : \$ 1,225,000
Building Size : 110 sqm
View : <https://www.topperrealestate.com.au/sale/qld/gold-coast/coolangatta/residential/apartment/7181313>



Michelle Topper
0400362639

501/215 Boundary Street, Coolangatta

🛏️ 2 🚿 2 🏠 1

internal: 100 m² | external: 18 m² | total: 118 m²

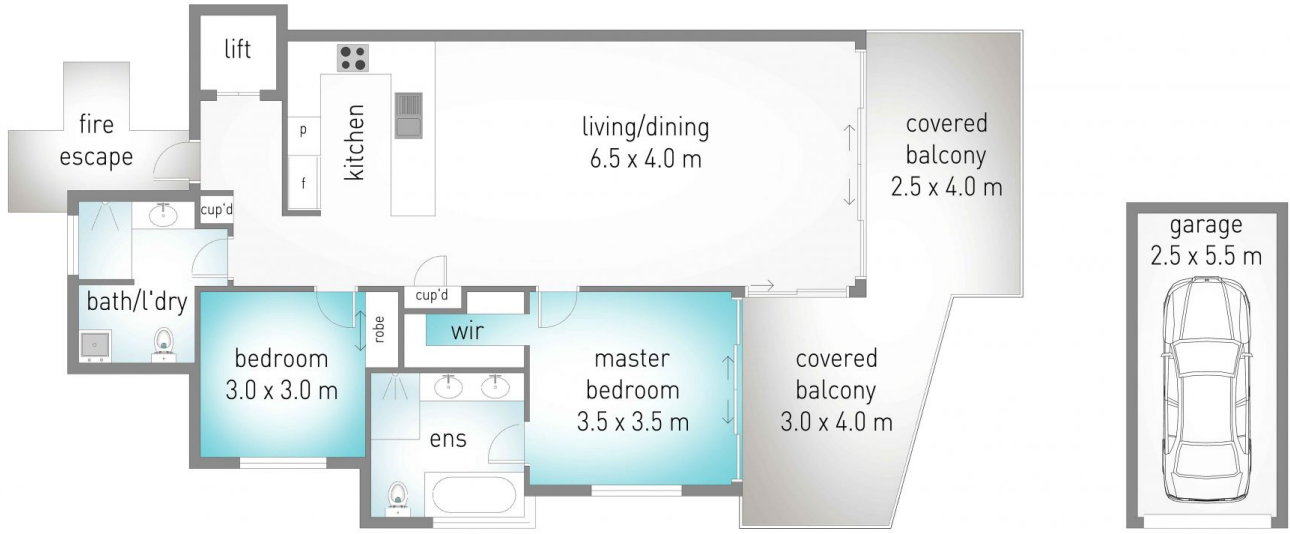

Dimensions are approximate. All information contained herein is gathered from sources we believe to be reliable. However we cannot guarantee its accuracy and interested persons should rely on their own enquiries.

